

# TERAFLEX

## INSTALLATION GUIDE

# Installation Guide for the JK Wrangler 2.5" Performance Budget Boost

These instructions apply to the following kit part numbers

- 1355200 2.5" spacer kit - no shocks
- 1355210 2.5" spacer kit with adapters to reuse factory shocks
- 1255200 2.5" spacer kit with new shocks

**Note:** to take full advantage of the TeraFlex Performance Budget Boost, longer shocks or adapters should be installed along with the spacer kit.

### Rear Installation

1. Jack up the vehicle by the frame and secure with jack stands.
2. Remove the wheels.
3. Remove the rear shocks.



4. Remove the rear springs.
5. Place the rear spring rubber isolator on the rear spacer and pop it into place.



6. Install the rear spacer by pushing the spacer into position. It will pop into place and will hold itself in position.
7. Re-install the rear spring.



8. Reinstall the factory shocks, adapters or new shocks depending on your kit.
9. Install the rear lower bumpstops to the existing pad on the rear axle using the supplied nuts, bolts and washers to secure it to the axle.
10. Install the lowering bracket for the rear brake line with the supplied hardware.



11. Complete steps 1-10 on the other side of the vehicle.
  12. Support the rear axle with a floor jack and remove the rear trackbar bolt at the frame end.
- Note:** A new drop bracket is included in the Budget Boost kit.

**Tera Manufacturing, Inc.**  
5251 South Commerce Dr.  
Murray, Utah 84107  
Phone/801.288.2585  
Fax/801.713.2313  
www.teraflex.biz

**Note:** With our longer shocks or shock extensions the factory left rear tire may rub on the sway bar at full droop. The tire will not rub at normal ride height.

**To take full advantage of the Budget Boost suspension travel, wheel spacers or after market wheels are required.**

Revised 10 April 2008

13. Use the supplied template to mark and drill a 3/8 hole in the factory track bar bracket as shown in the photo.

14. Install the new drop bracket placing the spacer inside so the new bracket is not crushed when the mounting bolt is tightened.

15. Reinstall the rear trackbar using the original hardware.  
The rear installation is now complete.

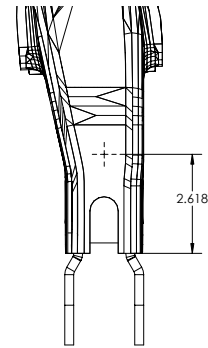

the bolts to avoid rubbing on the frame or sidewall.

### **Front Installation**

16. Remove the front shocks.  
17. Remove the front springs.  
18. Remove the front spring rubber isolator.

19. Install the front budget boost spacer onto the spring tower, followed by the stock rubber isolator.

20. Remove the stock yellow bumpstop from the spring tower. Using grease, lube the bumpstop to allow it to pop into place in the supplied bumpstop extension.

21. Use grease to lube the bumpstop extension and pop it back into the spring tower.

22. Re-install the front spring.

23. Reinstall the front shock absorber, adapter or new shock.

24. Complete steps 16-23 on the other side of the vehicle.

25. Remove stock rear swaybar links and move them to the front swaybar.

26. Discard factory front swaybar links.

27. Install new rear swaybar links, provided in the kit, on the inside of the sway bar and axle brackets with special care when placing



28. Reinstall the wheels or install new aftermarket wheels and tires. The vehicle lift is now complete.  
29. Properly align the vehicle before driving the vehicle.  
30. Re-torque all nuts and bolts after 300 miles.



Shock adapters front and rear  
- Kit 001355210 only

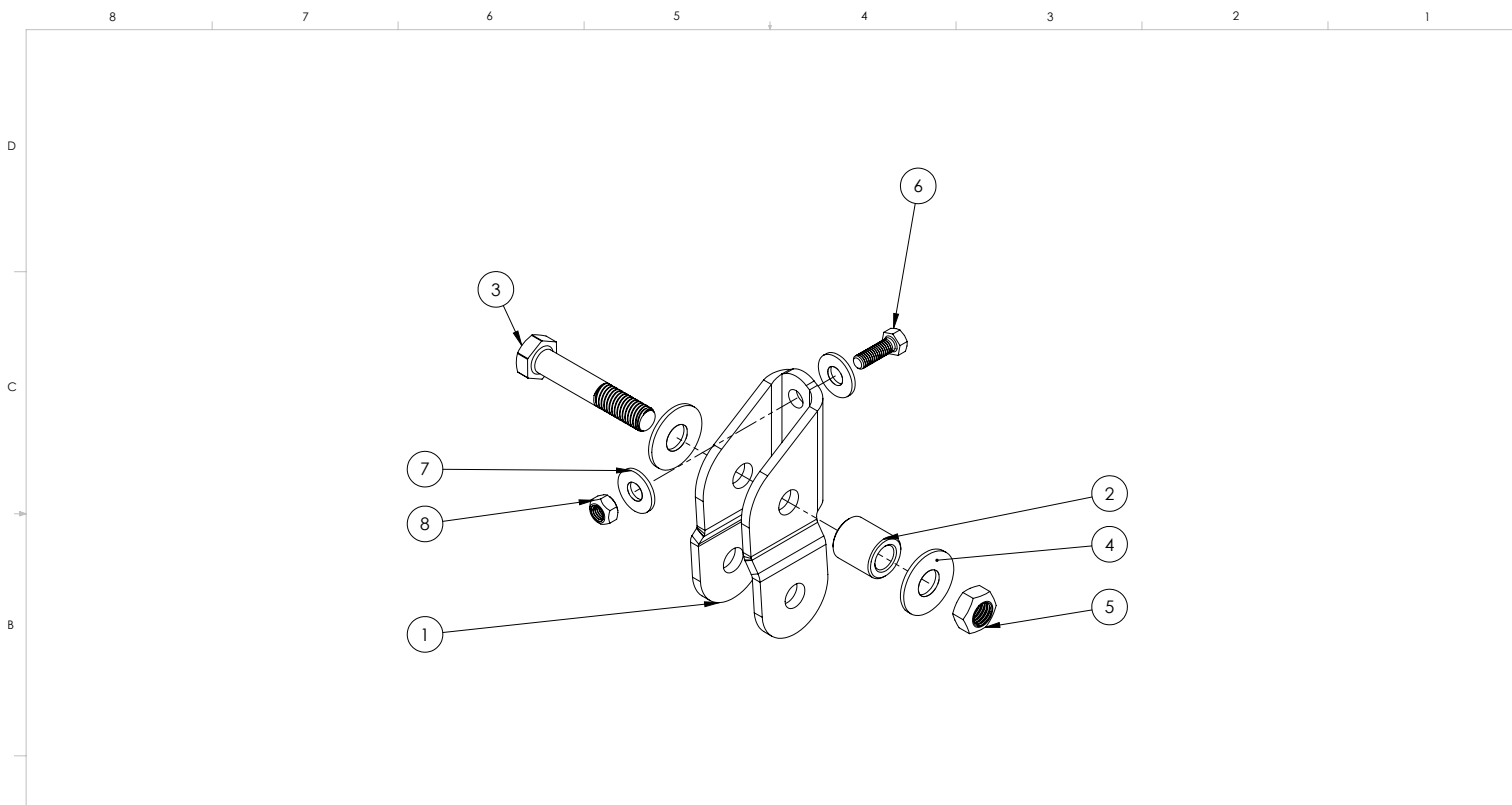

**MAINTENANCE INFORMATION:**

It is the buyer's responsibility to have all suspension, drivetrain, steering, and other components checked for proper tightness and torque after the first 100 miles and every 3000 miles after that.

**NOTICE TO INSTALLER:**

The enclosed "Warning to Driver" sticker must be installed in the vehicle in driver's view. This sticker is to act as a constant safety reminder when operating the vehicle. It is your responsibility as the equipment installer to install the provided sticker and to forward the product instructions to the vehicle's owner for review. If a "Warning to Driver" sticker or product installation guide were not included in the kit, FREE replacement stickers and instructions are available by request. It is the installer's duty to ensure a safe and controllable vehicle after the modifications have been performed.

**WARNING:**

Neither the seller nor the manufacturer will be liable for any loss, damage, or injury directly or indirectly arising from the use of or inability to determine the use of these products. Before using, the user shall determine the suitability of the products for its intended use, and the user shall assume all responsibility and risk in connection therewith.

**WARNING TO DRIVER:**

This vehicle has been modified to enhance off road performance and has unique handling characteristics. Because of the higher center of gravity and larger tires, this vehicle handles and reacts differently than many passenger cars, both on and off road. You must drive it safely! Extreme care should be taken to prevent vehicle rollover or loss of control, which can result in serious injury or death. Avoid sudden sharp turns or abrupt maneuvers. Generally, braking performance and capabilities are decreased when significantly larger/heavier tires are used, especially when used in combination with transfer case low-range reduction kits. Take this into consideration while driving. Do not add, alter or fabricate any factory or aftermarket parts to increase vehicle height over the intended height of the Tera Manufacturing product purchased. Mixing component brand is not recommended. Tera Manufacturing will not be responsible for any altered product or any improper installation or use of our products. We will be happy to answer any questions concerning the design, function, and correct use of our products. It is ultimately the buyer's responsibility to have all bolts/nuts checked for tightness after the first 100 miles and then every 3000 miles. Wheel alignment, steering system, suspension and drive line systems must be inspected by a qualified professional mechanic at least every 3000 miles.

**TERAFLEX PRODUCT WARRANTY:**

Tera Manufacturing warrants TeraFlex Suspension products to the original retail purchaser to be free of defects in material and workmanship for as long as the original purchaser owns the vehicle on which products were originally installed.

Failure to complete regular maintenance (grease every 3000 miles) on TeraFlex FlexArms will void this warranty. All other conditions of the standard Tera Mfg. product warranty apply.

All TeraLow products are covered by Tera's two (2) year warranty to be free of defects in material and workmanship for two year's from date purchased.

Tera axles are covered by a 12-month warranty to be free of defects in materials and workmanship.

The TeraFlex T-Locker is covered by a three (3) year warranty to be free of defects in materials and workmanship.

This warranty does not cover or include product finish, improperly installed or applied products, improperly maintained products, products or components used for racing or competition or damage due to abuse or neglect, products that fail due to the use of larger tire and wheel combinations.

All returns must be accompanied by an original invoice. It is the customer's responsibility to remove the product from the vehicle. Shipping charges are the responsibility of the customer. Tera Manufacturing will pay the return freight.

This warranty is for the replacement or repair of defective TeraFlex products only and does not include freight charges, labor charges for removal of or installation of TeraFlex or related products or components, costs incurred due to down time of the vehicle, or lost profits due to vehicle down time.

A returned goods authorization number (RGA#) must accompany any returned products. For more information please contact a TeraFlex customer service representative.

