

400 W. Artesia Blvd.  
Compton, CA 90220  
Fax: (310) 747-3912  
Ph: 1-800-776-0767  
E-Mail: info@procompusa.com  
Website: www.procompusa.com

Latest Revision:  
11.2.2022



---

---

## PRO COMP SUSPENSION

**This kit can be used in conjunction with any Pro Comp 0" to 8" lift kit**

**222582B/ PR  
Dual Steering Stabilizer Kit  
2005-2022 4WD Ford F250/350**

**READ INSTRUCTIONS THOROUGHLY AND COMPLETELY BEFORE BEGINNING INSTALLATION. INSTALLATION BY A CERTIFIED PROFESSIONAL MECHANIC IS HIGHLY RECOMMENDED. PRO COMP IS NOT RESPONSIBLE FOR ANY DAMAGE OR FAILURE RESULTING FROM IMPROPER INSTALLATION. THIS DOCUMENT CONTAINS VERY IMPORTANT INFORMATION THAT INCLUDES WARRANTY INFORMATION AND INSTRUCTIONS FOR RESOLVING PROBLEMS YOU MAY ENCOUNTER. PLEASE KEEP IT IN THE VEHICLE AS A PERMANENT RECORD.**

| <b>Part #</b>  | <b>Description</b>                         | <b>Qty.</b> | <b>Illus.</b> | <b>Page</b> |
|----------------|--|-------------|---------------|-------------|
| ZX2904         | ZINC MONOTUBE STEERING STABILIZER          | 2           | 2             | 4           |
| 91-5368        | CENTER BRACKET                             | 1           | 1,2           | 4           |
| 91-5372        | CENTER BRACKET UPPER PLATE                 | 1           | 2             | 4           |
| 91-5373        | TIE ROD BRACKET                            | 2           | 1,2           | 4           |
| 020106         | HARDWARE PACK: Tie Rod Bracket-3/8" U-Bolt | 2           | 1             | 4           |
| 020108         | HARDWARE PACK: Center Bracket-7/16" U-Bolt | 2           | 1             | 4           |
| 90-6253        | HARDWARE PACK: Center Bracket              | 1           | -             | -           |
| 70-0503001800  | 1/2" X 3" Gr. 8 HEX BOLT                   | 2           | 2             | 4           |
| 72-05000100816 | 1/2" USS Gr. C STOVER NUT                  | 2           | 2             | 4           |
| 73-05000030    | 1/2" Gr. 8 HARDENED FLAT WASHER            | 4           | 2             | 4           |
| 90-6683        | HARDWARE PACK: Tie Rod Brackets            | 1           | -             | -           |
| 70-0502501800  | 1/2" X 2 1/2" Gr. 8 HEX BOLT               | 2           | 2             | 4           |
| 72-050100816   | 1/2" USS Gr. 8 STOVER NUT                  | 2           | 2             | 4           |
| 73-05000034    | 1/2" SAE Gr. 8 HARDENED FLAT WASHER        | 4           | 2             | 4           |
| 90-6401        | HARDWARE PACK: Center Bracket              | 1           | -             | -           |
| 43FNNE8Y       | 7/16"-20 Gr. 8 NYLOC NUT                   | 4           | 1             | 4           |
| 43NWHDY/SAE    | 7/16" SAE Gr. 8 HARDENED WASHERS           | 4           | 1             | 4           |
| 90-6666        | HARDWARE PACK: Center Bracket Upper Plate  | 1           | -             | -           |
| 70-0501251800  | 1/2" X 1 1/4" Gr. 8 HEX BOLT               | 2           | 2             | 4           |
| 73-05000034    | 1/2" SAE Gr. 8 WASHER                      | 4           | 2             | 4           |
| 72-050100816   | 1/2" USS Gr. 8 STOVER NUT                  | 2           | 2             | 4           |

**RECOMMENDED EQUIPMENT**  
**22415: Rear Leaf Springs (99-07)**  
**22518: Rear Leaf Springs (08-10)**  
**5480: Carrier Bearing Shim Kit**  
**599: Alignment Cam Kit**  
**72400: Traction Bar Kit**  
**72099: Traction Bar Mount Kit**  
**99-400: 4 Degree Rear Axle Kit**

## INSTALLATION INSTRUCTIONS:

1. Position your vehicle on a smooth, flat, hard surface (i.e. concrete or asphalt). Block the rear tires and set the emergency brake.
2. **OPTIONAL:** Remove the factory steering stabilizer from the vehicle and discard.
3. **REMOVE THE WIRE OR STAMPED RETAINERS AND CLAMPS** out board of the tie rod pinch clamps. Failure to remove these factory retainers will result in damage to the Pro Comp stabilizer and brackets. Tighten the tie rod pinch clamps after the retainers are removed.
4. Center the front wheels under the vehicle. For the **2005-2007** model, on both sides install the tie rod brackets (**91-5373**) to the tie rods approximately **1"** from the edge of the threads. For the **2008** model, on both sides install the tie rod brackets to the flat spots on the bottom of the tie rod using the supplied **3/8"** U-bolts from kit (**020106**). Torque the **3/8"** hardware according to the torque chart on page 5. See ILLUSTRATION 1.  
***NOTE: Be sure the brackets are facing toward the front of the vehicle.***
5. Install the center bracket (**91-5368**) to the pass side of the axle using **7/16"** U-bolts from pack (**020108**) as shown in ILLUSTRATION 1. Torque the **7/16"** hardware from pack (**90-6401**) according to the torque chart on page 5.  
***NOTE: The inner U-bolt should butt up against the passenger side edge of the differential center section.***
6. Install the center bracket upper plate (**91-5372**) to the center bracket using the supplied **1/2" X 1 1/4"** bolts and hardware from pack (**90-6666**). Torque the **1/2"** hardware according to the torque chart on page 5.
7. Insert the shaft ends of the steering stabilizers (**PR2904**), to the center bracket (**91-5368**) using the supplied **1/2" X 3"** shock bolts and hardware from pack (**90-6253**). See ILLUSTRATION 2.
8. Bolt the body end of the stabilizers (**223500**) to the newly installed stabilizer mount brackets using the supplied **1/2" X 2 1/2"** bolts and hardware from pack (**90-6683**). Torque the **1/2"** mounting bolt hardware according to the torque chart below. See ILLUSTRATION 2.
9. If necessary, adjust the brackets so that each stabilizer has an equal amount of shaft showing on each side. Re-torque the U-bolt hardware to prevent the brackets from moving.
10. Cycle the steering full left and full right to assure there are no binding, clearance issues or bottoming out and/or over extension of the stabilizers.
11. Re-torque all the newly installed hardware after 100 miles or any off road use.

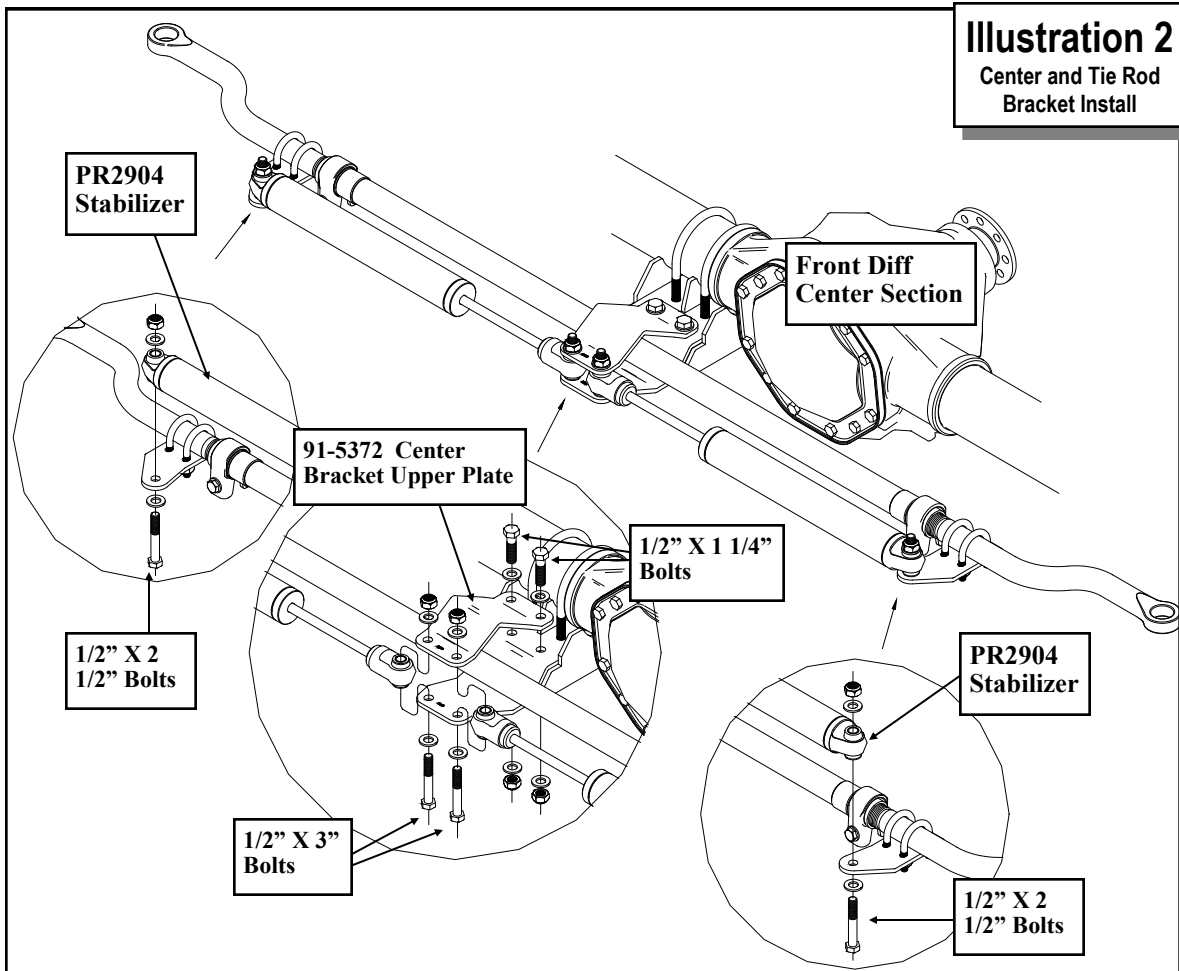
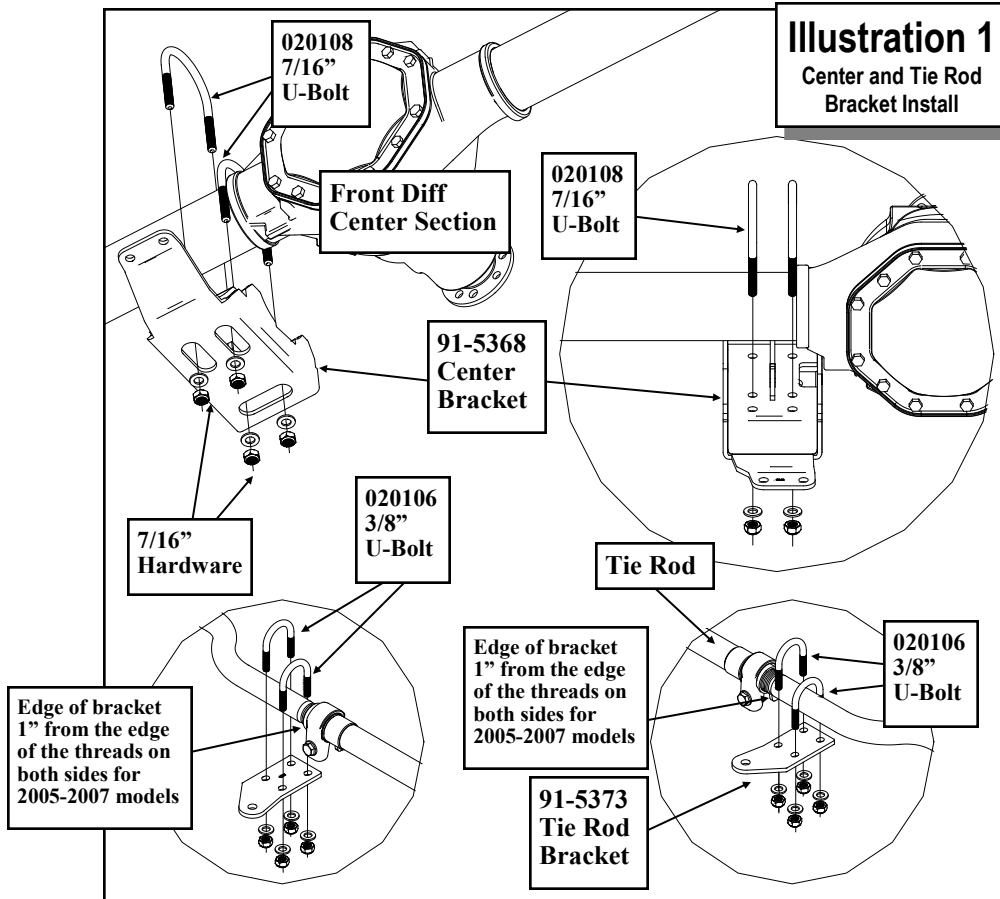

Use this only as a guide for hardware without a called out torque specification in the instruction manual.

| <b>Bolt Torque and ID</b>        |         |         |                      |           |            |            |
|----------------------------------|---------|---------|----------------------|-----------|------------|------------|
| <b>Decimal System</b>            |         |         | <b>Metric System</b> |           |            |            |
| All Torques in Ft. Lbs. Maximums |         |         |                      |           |            |            |
| Bolt Size                        | Grade 5 | Grade 8 | Bolt Size            | Class 9.8 | Class 10.9 | Class 12.9 |
| 5/16                             | 15      | 20      | M6                   | 5         | 9          | 12         |
| 3/8                              | 30      | 45      | M8                   | 18        | 23         | 27         |
| 7/16                             | 45      | 60      | M10                  | 32        | 45         | 50         |
| 1/2                              | 65      | 90      | M12                  | 55        | 75         | 90         |
| 9/16                             | 95      | 130     | M14                  | 85        | 120        | 145        |
| 5/8                              | 135     | 175     | M16                  | 130       | 165        | 210        |
| 3/4                              | 185     | 280     | M18                  | 170       | 240        | 290        |

1/2-13x1.75 HHCS

D T L X

Grade 5 Grade 8  
(No. of Marks + 2)

M12-1.25x50 HHCS

D T L X

P

G = Grade (Bolt Strength)  
D = Nominal Diameter (Inches)  
T = Thread Count (Threads per Inch)  
L = Length (Inches)  
X = Description (Hex Head Cap Screw)

P = Property Class (Bolt Strength)  
D = Nominal Diameter (Millimeters)  
T = Thread Pitch (Thread Width, mm)  
L = Length (Millimeters)  
X = Description (Hex Head Cap Screw)

**Safety Warning**

**MISUSE OF THIS PRODUCT COULD LEAD TO INJURY OR DEATH**

Suspension systems or components that enhance the on and off-road performance of your vehicle may cause it to handle differently than it did from the factory. Extreme care must be used to prevent loss of control or vehicle rollover during abrupt maneuvers. Always operate your vehicle at reduced speeds to ensure your ability to control your vehicle under all driving conditions. Failure to drive safely may result in serious injury or death to driver and passengers.

Driver and passengers must ALWAYS wear your seat belts, avoid quick sharp turns and other sudden maneuvers. PRO COMP does not recommend the combined use of suspension lifts, body lifts, or other lifting devices.

You should never operate your vehicle under the influence of alcohol or drugs.

Constant maintenance is required to keep your vehicle safe. Thoroughly inspect your vehicle before and after every off-road use.

It is the responsibility of the retailer and/or the installer to review all state and local laws, with the end user of this product, related to bumper height laws and the lifting of their vehicle before the purchase and installation of any PRO COMP products. It is the responsibility of the driver/s to check their surrounding area for obstructions, people, and animals before moving the vehicle. All raised vehicles have increased blind spots; damage, injury and/or death can occur if these instructions are not followed.

**Installation Warning**

All steps and procedures described in these instructions were performed while the vehicle was properly supported on a two post vehicle lift with safety jacks.

Use caution during all disassembly and assembly steps to insure suspension components are not over extend-ed causing damage to any vehicle components and parts included in this kit.

Included instructions are guidelines only for recommended procedures and are not meant to be definitive. Installer is responsible to insure a safe and controllable vehicle after performing modifications.

PRO COMP recommends the use of an OE Service Manual for model/year of vehicle when disassembly and assembly of factory and related components.

Unless otherwise specified, tighten all bolts and fasteners to standard torque specifications listed within the OE Service Manual. Suspension components that use rubber or urethane bushings should be tightened with the vehicle at normal ride height. This will prevent premature wear or failure of the bushing and maintain ride comfort.

Larger tire and wheel combinations may increase leverage on suspension, steering, and related components. Due to payload options and initial ride height variances, the amount of lift is a base figure. Final ride height dimensions may vary in accordance to original vehicle ride height. Always measure the vehicle ride height prior to beginning installation.

Unless otherwise specified, tighten all bolts and fasteners to standard torque specifications listed within the OE Service Manual. Suspension components that use rubber or urethane bushings should be tightened with the vehicle at normal ride height. This will prevent premature wear or failure of the bushing and maintain ride comfort.

Larger tire and wheel combinations may increase leverage on suspension, steering, and related components. Due to payload options and initial ride height variances, the amount of lift is a base figure. Final ride height dimensions may vary in accordance to original vehicle ride height. Always measure the vehicle ride height prior to beginning installation.

### **SAEJ2492 Warning**

By installing this product, you acknowledge that the suspension of this vehicle has been modified. As a result, this vehicle may handle differently than that of factory-equipped vehicles. As with any vehicle, extreme care must be used to prevent loss of control or roll-over during sharp turns or abrupt maneuvers. Always wear seat belts, allow more time and distance for braking, and drive safely, recognizing that reduced speeds and specialized driving techniques may be required. Failure to drive this vehicle safely may result in serious injury or death. Do not drive this vehicle unless you are familiar with its unique handling characteristics and are confident of your ability to maintain control under all driving conditions. Some modifications (and combinations of modifications) are not recommended and may not be permitted in your state. Consult your owner's manual, the instructions accompanying this product, and state laws before undertaking these modifications. You are responsible for the legality and safety of the vehicle you modify using these components.

### **Headlamp Warning**

A lifted vehicle may have different headlight aim performance. PRO COMP recommends marking and recording the headlight beam position before kit installation and then adjusting, if necessary, the headlamps to the same height settings after kit installation. Set the vehicle on a level surface 10' to 15' from a solid wall or garage door. (This is a general distance with some manufacturers requiring different distances.) Note the top height of the low beam's bright spot, the top of the most intense part of the beam, for driver and passenger side. Height may vary from side to side. Repeat this procedure and adjust after lift kit is installed. Adjust if the aim is off by turning the adjusters gradually (a quarter of a turn) and looking to see where the new alignment falls. It may be easier to block one headlamp while adjusting the other. Consult the owner operation manual for procedures to adjust headlights - many automakers offer headlight aiming specs. Some states have their own specifications when it comes to headlight aim, so it's best to follow those rules when aligning headlights.

**FAILURE TO PERFORM THE POST INSPECTION CHECKS MAY RESULT IN VEHICLE COMPONENT DAMAGE AND/OR PERSONAL INJURY OR DEATH TO THE DRIVER AND/OR OTHERS.**

### **Final Checks & Adjustments**

Once the vehicle is lowered to the ground, check all parts which have rubber or urethane components to ensure proper torque. Torque lug nuts to the wheel manufacturer specs. Move vehicle backwards and forwards a short distance to allow suspension components to adjust. Turn the front wheels completely left then right and verify adequate tire, wheel, brake line, and ABS wire clearance. Test and inspect steering, brake and suspension components for tightness and proper operation. Inspect brakes hoses and ABS lines for adequate slack at full extension, adjust as necessary.

**RECHECK ALL HARDWARE FOR PROPER TORQUE VALUES AFTER 500 MILES, AND THEN PERIODICALLY AT EACH SERVICE INTERVAL THERAFTER.**

### **Vehicle Handling Warning**

Increasing the height of your vehicle raises the center of gravity and can affect stability and control. Use caution on turns and when making steering corrections.

Vehicles with larger tires and wheels will handle differently than stock vehicles. Take time to familiarize yourself with the handling of your vehicle.

### **Wheel Alignment/Headlamp Adjustment**

It is necessary to have a proper and professional wheel alignment performed by a certified alignment technician. Align the vehicle to factory specifications. It is recommended that your vehicle alignment be checked after any off-road driving.

In addition to your vehicle alignment, for your safety and others, it is necessary to check and adjust your vehicle headlamps for proper aim and alignment. If the vehicle is equipped with active or passive safety/collision monitoring and/or avoidance systems including, but not limited to, camera- or radar-based systems, check and adjust your vehicle's systems for proper aim and function.

**PRO COMP will gladly answer any questions concerning the design, function, maintenance and correct use of our products. Please make sure your Dealer/Installer explains and delivers all warning notices, warranty forms and instruction sheets included with PRO COMP product.**

Application listings in this catalog have been carefully fit checked for each model and year denoted. However, PRO COMP reserves the right to update as necessary, without notice, and will not be held responsible for misprints, changes or variations made by vehicle manufacturers. Please call when in question regarding new model year, vehicles not listed by specific body or chassis styles or vehicles not originally distributed in the USA.

**Please note that certain mechanical aspects of any suspension lift product may accelerate ordinary wear of original equipment components.** Further, installation of certain PRO COMP products may void the vehicle's factory warranty as it pertains to certain covered parts; it is the consumer's responsibility to check with their local dealer for warranty coverage before installation of the lift.

### **Warranty and Return policy:**

PRO COMP warrants its full line of products to be free from defects in workmanship and materials. PRO COMP'S obligation under this warranty is limited to repair or replacement, at PRO COMP's option, of the defective product. Any and all costs of removal, installation, freight or incidental or consequential damages are expressly excluded from this warranty. PRO COMP is not responsible for damages and / or warranty of other vehicle parts related or non-related to the installation of PRO COMP product. A consumer who makes the decision to modify his vehicle with aftermarket components of any kind will assume all risk and responsibility for potential damages incurred as a result of their chosen modifications. Warranty coverage does not include consumer opinions regarding ride comfort, fitment and design. Warranty claims can be made directly with PRO COMP or at any factory authorized PRO COMP dealer.



**The PRO COMP PROMISE WARRANTY**

At Pro Comp, we know you have many choices when selecting products to personalize your vehicle. You should demand nothing but the highest quality available and have total confidence that the products you selected are the best in the industry. It is for these reasons that Pro Comp Suspension products are backed by the best warranty in the industry...the Pro Comp Promise!

Pro Comp promises that its products will last a lifetime or we will replace it free of charge. It's that simple! Because of our commitment to quality and manufacturing excellence, we are able to stand behind our products. FOREVER.

It is Pro Comp's Promise that if one of our suspension products breaks not due to misuse, neglect or vandalism, we will replace it. Whether you are the original purchaser or not, you can be assured that we will make it right. The Pro Comp Promise covers all suspension products including shocks and steering stabilizers. Buy Pro Comp Suspension today and enjoy it for the rest of your life!

That's our Pro Comp Promise!

**Notice to Owner, Operator, Dealer and Installer:**

Vehicles that have been enhanced for off-road performance often have unique handling characteristics due to the higher center of gravity and larger tires. This vehicle may handle, react and stop differently than many passenger cars or unmodified vehicles, both on and off-road. You must drive your vehicle safely! Extreme care should always be taken to prevent vehicle rollover or loss of control, which can result in serious injury or even death. Always avoid sudden sharp turns or abrupt maneuvers and allow more time and distance for braking! Pro Comp reminds you to fasten your seat belts at all times and reduce speed! We will gladly answer any questions concerning the design, function, maintenance and correct use of our products.

Please make sure that the Dealer / Installer explains and delivers all warning notices, warranty forms and instruction sheets included with Pro Comp product.

**Warranty and Return Policy:**

Pro Comp warrants its full line of products to be free from defects in workmanship and materials for the life of the product. Pro Comp's obligation under this warranty is limited to repair or replacement, at Pro Comp's option, of the defective product. Any and all costs of removal, installation, freight or incidental or consequential damages are expressly excluded from this warranty. Pro Comp is not responsible for damages and / or warranty of other vehicle parts related or non-related to the installation of Pro Comp product. A consumer who makes the decision to modify his vehicle with aftermarket components of any kind will assume all risk and responsibility for potential damages incurred as a result of their chosen modifications. Warranty coverage does not include consumer opinions regarding ride comfort, fitment and design. Warranty claims can be made directly with Pro Comp or at any factory authorized Pro Comp dealer.

**IMPORTANT!** To validate the warranty on this purchase please be sure to mail in the warranty card.

Claims not covered under warranty:

- \* Parts subject to normal wear; this includes bushings, bump stops, ball joints, tie rod ends and heim joints.
- \* Finish after 90 days.
- \* Damage caused as a result of not following recommendations or requirements called out in the installation manuals.

Pro Comp Monotube coil-over shocks are considered a serviceable shock with a one-year warranty against leakage only. Rebuild service and replacement parts will be available and sold separately by Pro Comp. Contact Pro Comp for specific service charges. Pro Comp accepts no responsibility for any altered product, improper installation, lack of or improper maintenance or improper use of our products.

**E-Mail: [info@procompusa.com](mailto:info@procompusa.com)**  
**Website: [www.procompusa.com](http://www.procompusa.com)**  
**Fax: (310) 747-3912**  
**Ph: 1-800-776-0767**

|   |
|---|
| <u>PLACE</u><br><b>WARRANTY REGISTRATION</b><br><u>NUMBER</u><br><b>HERE:</b> _____ |
|---|

**Revision Page**

**11.2.22:** Updated Model Fitment to include 2022. and template.