

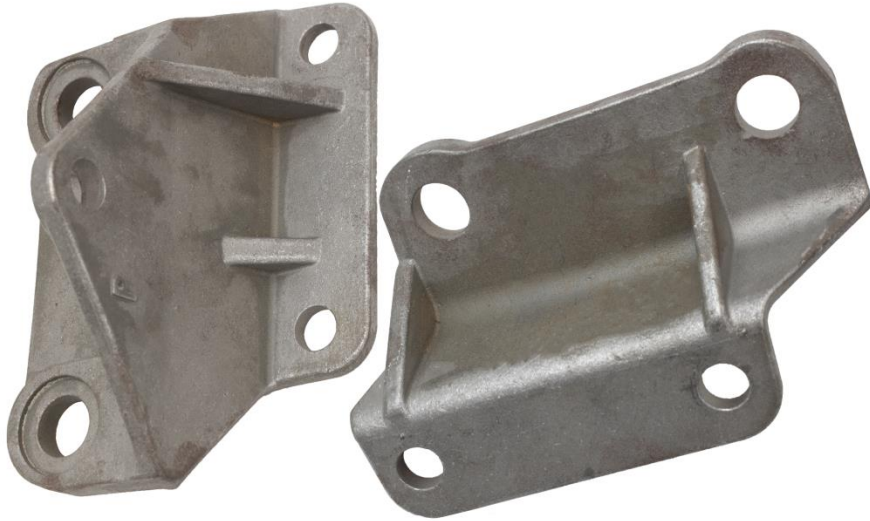

**RUST  
BUSTER**  
FRAMEWORKS

**RB1004**  
**Jeep® CJ**  
**Sway Bar Mount Brackets**



**REQUIRED TOOLS**

Jack Stands or Lift  
Paint/Primer  
Sockets & Ratchet

**KIT CONTAINS**

Sway Bar Mount Brackets

**QTY**

1



**RB1004**  
**Jeep® CJ**  
**Sway Bar Mount Brackets**

**1) PREPARING YOUR VEHICLE**

Begin by disconnecting your battery prior to starting your installation.

Inspect your vehicle for leaking fuel lines, fuel tank and engine components. If you have fuel leaks repair all leaks prior to starting your installation. If your fuel tank is near your welding area **remove your tank prior to welding.**

Remove all combustible items above the work area such as seats, carpets, padding, etc.

**Keep all flammable materials away from the vehicle work area.**

**2) PREPARING YOUR WORKSTATION**

Keep a fire extinguisher and water close by in the case of fire and make sure you always have a designated "Fire Watch" to assist during the cutting or welding phases.

Abide by all apprenticed welding safety standards and practices.

Always use appropriate welding eye protection, ear protection, and work and fire safety gloves during the installation and within the work area.



**WARNING!**

If you are unsure on how to perform the installation or how to operate any of the required tools listed above, it is **HIGHLY** advised that you enlist the work of a certified welder/installer.

Failure to follow proper safety precautions and instructions may result in serious injury. **The user assumes all liability when installing the product.**



# RB1004 Jeep® CJ Sway Bar Mount Brackets

### 3) PREPARING FOR YOUR INSTALL

Lift your vehicle.

Remove the front wheels and tires set them out of the way.

Support your rear axle using two jack stands for the driver and passenger sides.

Identify Passenger or Drivers bracket:

-Passenger side bracket has a beveled P marking.



-Drivers side bracket has a beveled D marking.



### 4) PAINT

If you choose, paint/primer your new Rust Buster Sway Bar Mount Brackets to seal and prevent future rust.

### 5) REMOVAL

Unbolt and remove your factory Sway bar mount brackets.

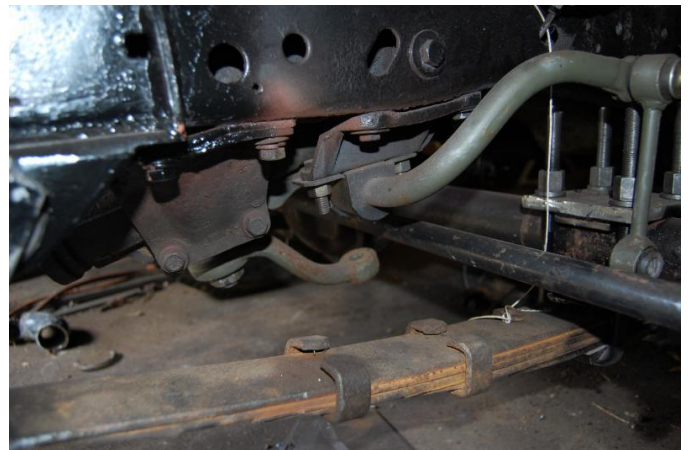

### 6) INSTALL

Reinstall your new sway bar mount brackets.