

# TAILGATE BAR

For proper installation and best possible fit, please read all instructions **BEFORE** you begin.  
For technical assistance or to obtain missing parts, please call Customer Relations at 1-800-328-2409.

## Important Safety Information



- Periodically check all components for tightness.
- Be sure to wear safety goggles while installing.
- When using power tools, read and understand all operating instructions.

## Contents

**NOTE:** Actual product may vary from illustration.



Tailgate Bar x1

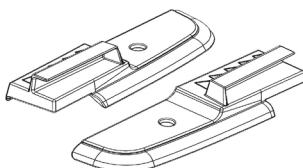

Tailgate Mount x2

## Tools Required

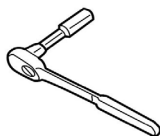

Ratchet & Extensions



Torx Bits



Safety Glasses

Attach the Tailgate Mount to the Jeep Rail using the hard top OEM Torx head screw. Insert the screw through the and into threaded holes in the top of the Jeep rail, and tighten.

Repeat the same step to the passenger side.

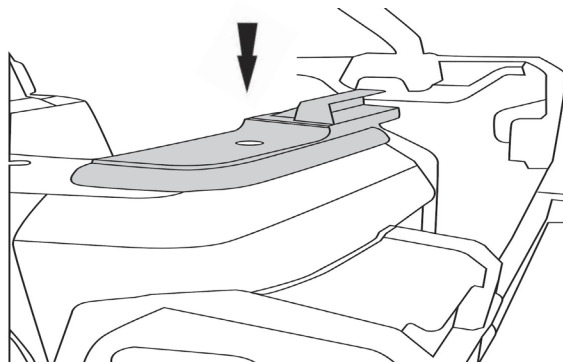

**1**

Slide the tailgate bar onto the bottom of the rear window.

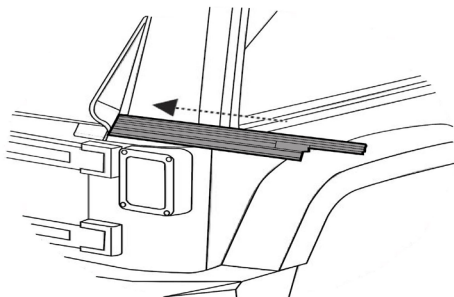

**2**

Insert the tailgate bar into the mount by pushing the bar against the mount and rotate bar downward.

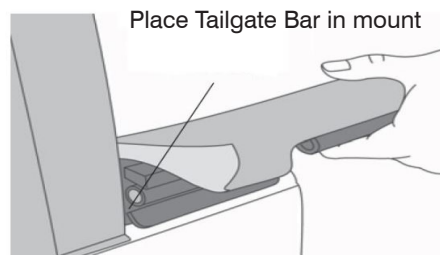

**3**

## Care and Cleaning

- Rampage parts are built to last. Use mild soap and dry clean cloth to wash Tailgate Bar.
- Do not use any harsh abrasive detergents or cleaning solvents of any kind.

## Congratulations!

You have purchased one of the many quality Rampage branded products offered by Lund International, Inc. We take the utmost pride in our products and want you to enjoy years of satisfaction from your investment. We have made every effort to ensure that your product is of the highest quality for fit, durability, finish, and ease of installation.



The material that your product is made from can be recycled. Please also consider recycling the packaging that your product came in.



800-328-2409 • Visit us at [Rampageproducts.com](http://Rampageproducts.com)

© 2019 Lund Motion Products, Inc. All rights reserved.  
mpage Products™ is a trademark of Lund Motion Products, Inc.

