



Revised: 04/10/2000

Explorer Competition Products, Inc. Chula Vista, CA USA

Ph: (619) 216-1444 • Fax: (619) 216-1474 • E-Mail: tech@explorerprocomp.com • Website: www.explorerprocomp.com

# INSTALLATION INSTRUCTIONS

## Part # 10000 Universal Light Bar

### PARTS LIST:

<u>ITEM</u>	<u>DESCRIPTION</u>	<u>QTY.</u>
20-10000-1	Light Bar, Universal	1
20-812098	Tab, "L" Mounting	2
90-6090	Hardware Pack Containing:	
70-05012515000	1/2" x 1 1/4" USS Gr. 5 Bolt	2
73-05000030	1/2" SAE Flat Washer	4
72-05000100512	1/2" USS Nyloc Nut	2
70-0371251500	3/8" x 1 1/4" USS Gr. 5 Bolt	4
73-03700030	3/8" SAE Flat Washer	8
72-03700100512	3/8" USS Nyloc Nut	4

### BEFORE YOU BEGIN:

- Read instructions and study the illustration before attempting installation. Separate parts according to the areas where they will be used. Placing the hardware with the brackets before you begin will save installation time.
- Check the parts and hardware against the parts list to assure that your kit is complete.
- Always wear safety glasses when using power tools.

**This item is designed as a decorative accessory item and is not designed as a replacement bumper. It is not intended to provide additional vehicle safety or protection.**

### INSTALLATION:

- 1) Determine the center of the universal light bar on the stock front bumper. Mark the hole locations of the long bracket to the top of the bumper. Center punch and drill 7/16" holes in these locations. Finger tighten the bracket to the bumper using the 3/8" hex bolts, washers and nyloc nuts provided.
- 2) Position the "L" brackets on the two outside tabs as shown in the illustration. Locate and mark the hole locations on the front side of the stock bumper. Drill 9/16" hole in these locations. Install the 1/2" hex bolt, washers and nyloc nuts provided.

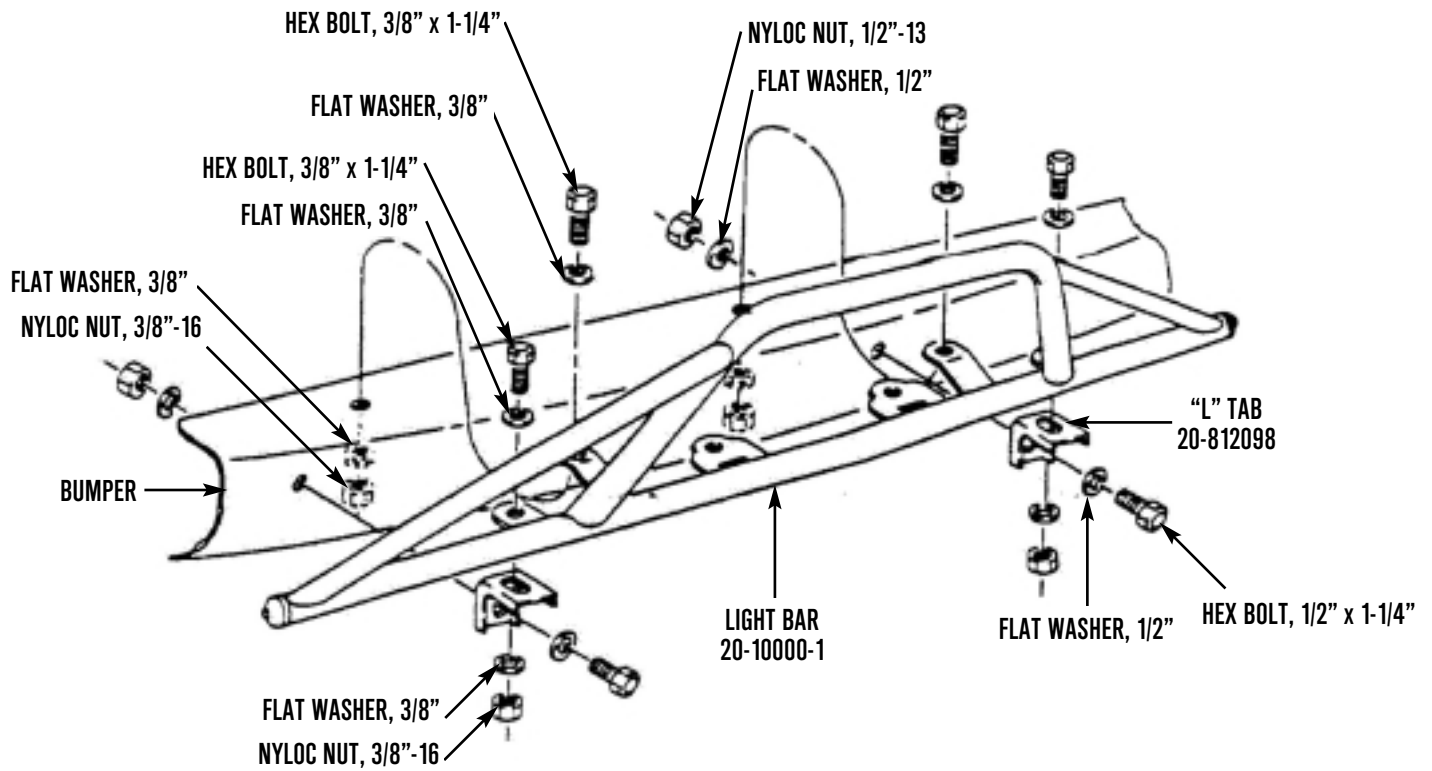

3) Align the universal light bar with the front bumper and tighten all hardware.

**NOTES:**

A) If you have to use the two inner tabs for mounting the light bar and you are using lights, use the bolt in the light to hold the light bar and "L" bracket together.

B) This item is designed to fit many applications. The "L" bracket may need to be shaped to fit some applications.